

HCC - Installing Wi-Fi Antenna Extension Kit

To improve Wi-Fi visibility to the router, we recommend using the Wi-Fi extension kit (model: **WIFI-EXT-KIT**). This is not a signal booster, but an option to get the antenna closer to the router. Going around corners, through obstructions, or just reducing the distance are appropriate applications for this product.

The extension kit comes with two separate cables and mounting hardware to install in $\frac{3}{4}$ " conduit. The thicker cable provides a 9' extension, while the thinner cable is 3.5' in length.

IMPORTANT: The 3.5' length cable is not used for the HCC Controller model. Use only one cable extension, as combining the two will incur a signal loss.

WIFI-EXT-KIT: Parts Included	Controller Models
Cable 9'	Used for HCC ^[1] and ACC2 ^[2] model controllers.
SMA Adapter (red cap)	Used only for HCC ^[1] model controllers.
Conduit Mounting Hardware	Used for HCC ^[1] and ACC2 ^[2] model controllers.

Please visit an authorized Hunter distributor near you using our interactive [Distributor Lookup](#) ^[3]

Steps	Illustrations
Step 1: Open the FRONT PANEL to access the antenna compartment.	

Step 2: Remove the three Phillips **SCREWS** on the left-hand side of the back of the panel.

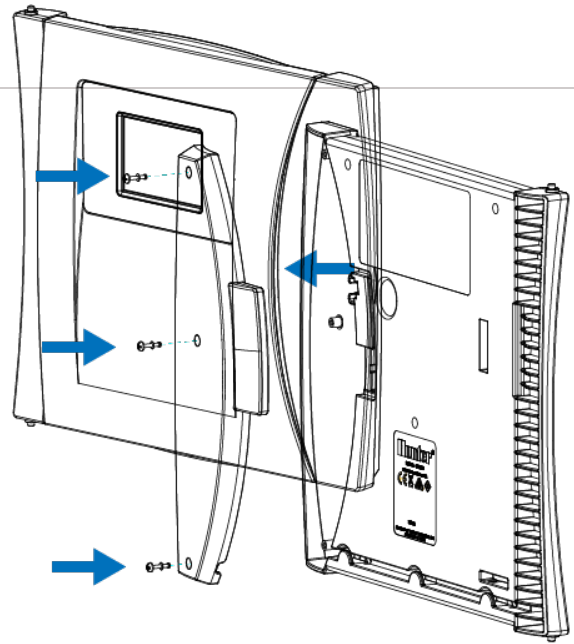

Step 3: Unthread the existing antenna. Thread on the included **SMA Adapter (red cap)** until hand tightened. Next, thread on the extension cable (9') until hand tightened. Attach the original antenna to the other end of the cable.

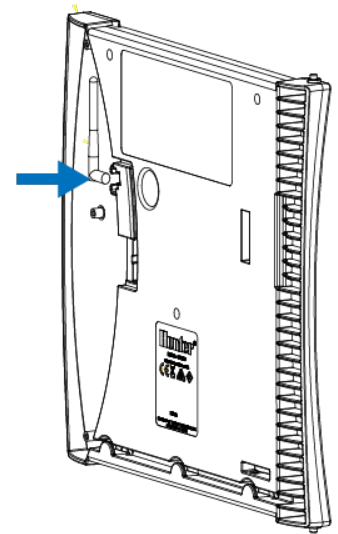

Step 4: Route antenna cable through the channel at the bottom of the facepack. Remember to re-install the plastic cover over the compartment. Note: Drilling into the cabinet is not recommended. Please only use existing conduit knockouts.

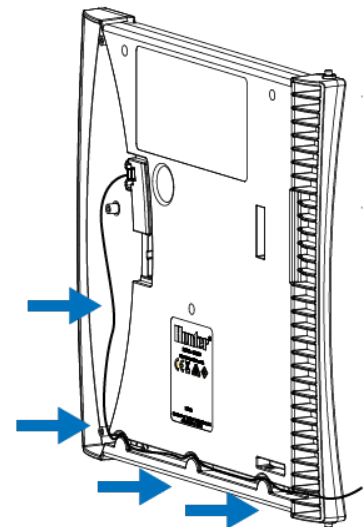

Step 5: Route the 9' antenna cable from enclosure through 3/4" (20 mm) plastic

electrical conduit. Use standard fittings to position the antenna where required. Do not exceed supplied cable length.

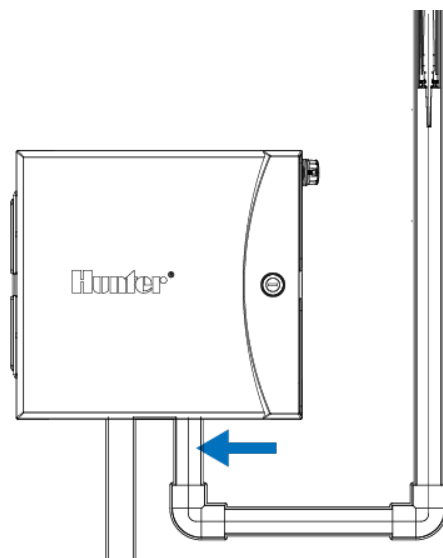

Step 6: Route cable and antenna through standard $\frac{3}{4}$ " (20 mm) threaded adapter with male threaded end up.

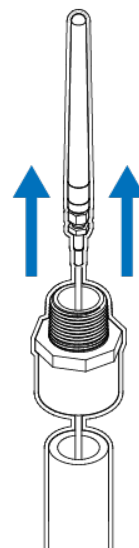

Step 7: Insert the antenna into the open side of the lower tube (fit the cable through the slot). Adjust holder length by sliding the upper body into the lower body.

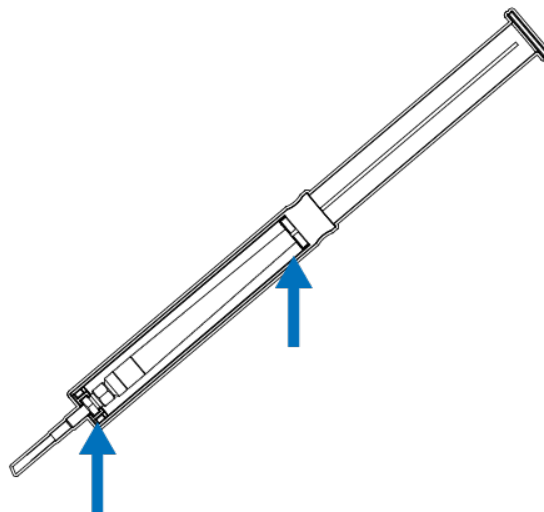

Step 8: Drop the antenna holder into threaded conduit fitting, and allow the holder

rim to rest on top of the fitting.

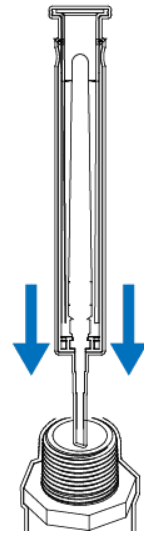

Step 9: Add threaded cap (recommended) or glue cap to prevent water entry and complete installation.

