

HPC - Upgrading Pro-C

The PRO-C model controller must be the NEWER PC- 400 version (blue buttons and solar sync dial position) with a date code of MARCH 2014 or newer. This date code is written on the white sticker inside the wiring compartment. Ensure you have a strong Wi-Fi signal. Wi-Fi connectivity can be tested on the HPC panel itself (signal strength is shown when you select a wireless network). If you have any issues connecting the controller to the router, please verify all Wi-Fi specifications [here](#) [1].

If you have the older model PC-300, the replacement controller is the HPC-400. If the station modules in your older unit are black, they will work in the HPC-400 model controller.

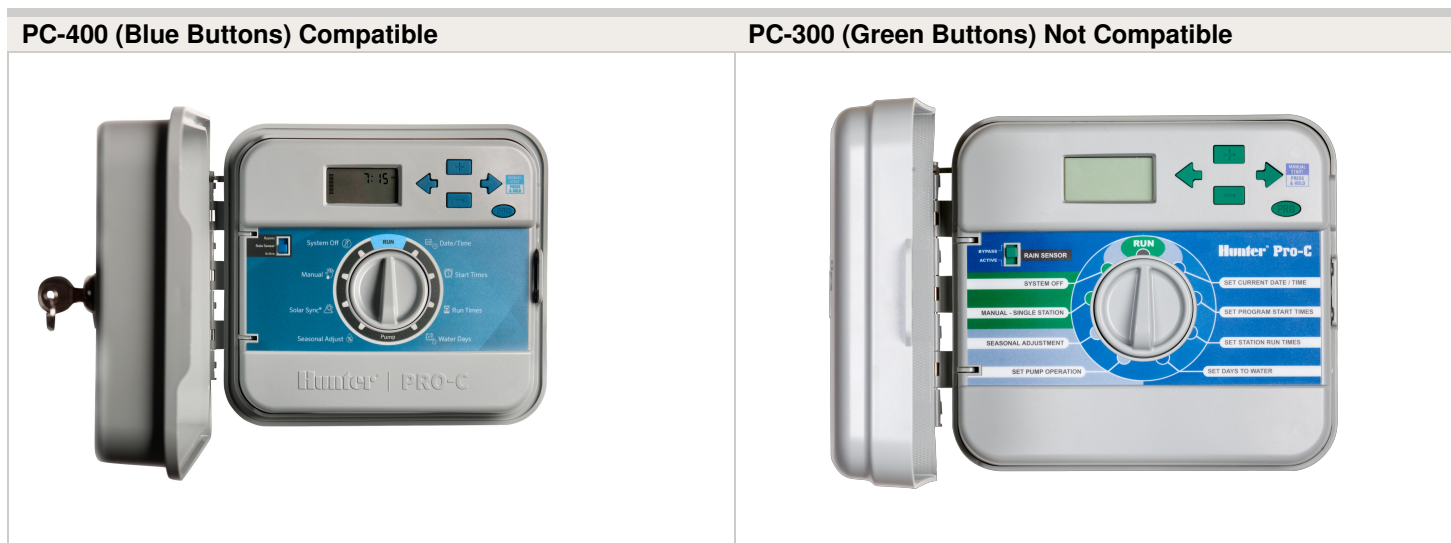

NOTE: The compatible ribbon design in this panel should have two rows of pins. The single row of pins would also indicate a panel that is *not* compatible.

Remove Pro-C Face Panel

1. Remove ribbon cable with power off.
2. Press down on the white hinge release button.
3. Remove face panel.

Install HPC-FP Face Panel

1. Press blue hinges together and attach a new HPC panel.
2. Reconnect ribbon cable
3. Close and turn the power on

STEPS



For information on the complete setup in the application, please visit our [USING THE APP](#) ^[2] section.